

Nifti-Reel: At last, I can launch my DSMB without stress!

Nifti-Reel



Manual

Contents

1.	HOW TO TRAIN TO LAUNCH A DSMB WITH THE NIFTI-REEL?	3
2.	HOW CAN THE NIFTI-REEL BE SO EASY TO USE?	3
2.1	THE DIFFICULTY OF MANAGING THE DSMB DEPENDS PRIMARILY ON HOW YOU STORE THE LINE	3
2.2	SOLUTION : A LONG JOURNEY TO RADICAL ERGONOMICS!	3
2.3	SUMMARY OF MY BENEFITS WHEN USING THE NIFTI-REEL	4
3.	NIFTI-REEL USER MANUAL	6
3.1	ON LAND: HOW TO PREPARE THE NIFTI-REEL AND THE DSMB	6
3.2	BEFORE A DIVE: HOW TO ATTACH THE DSMB TO THE NIFTI-REEL AND LOCK ITS SPOOL	7
3.3	HOW TO HOLD THE NIFTI-REEL (EVEN WITH THE THICKEST GLOVES)	8
3.4	HOW TO LAUNCH YOUR DSMB	9
3.5	WHAT HAPPENS DURING THE DSMB ASCENT	10
3.6	DURING YOUR ASCENT: HOW TO REWIND THE LINE	11
3.7	AT A STOP: HOW TO LOCK / UNLOCK THE SPOOL	12
3.8	BEFORE GETTING BACK ON BOARD: HOW TO LOCK THE SPOOL	13
3.9	ON LAND: WHEN SHOULD I RINSE MY NIFTI-REEL?	13
4.	TECHNICAL DOCUMENTATION	14
4.1	ON LAND: HOW TO ATTACH THE LINE TO THE SPOOL	14
4.2	ON LAND: HOW TO CHECK AND ADJUST THE BRAKE	15
4.3	ON LAND: HOW TO PERSONALIZE YOUR NIFTI-REEL	16
4.4	ON LAND: HOW TO DISASSEMBLE, CLEAN, AND REASSEMBLE THE NIFTI-REEL	17
4.5	ADD ATTACHMENT POINTS TO THE NIFTI-REEL. ATTACHING A SMALL DSMB	18
4.6	DIMENSIONS. WEIGHT. BUOYANCY. LINE	19
4.7	MATERIALS AND RESPECT OF THE ENVIRONMENT	20
4.8	NOTE : REWIND HANDLE, LINE STOP. BUNGEE STOPS.	21
4.9	NOTE : HOW TO MOUNT THE BRAKE	21
4.10	TRADEMARKS	22

Disclaimer – Important Safety Notice

This manual is not a diving course, and it does not replace a diving course:
Learning to dive safely requires several hours of training,
under the supervision and with the assistance of qualified instructors.

1. How to train to launch a DSMB with the Nifti-Reel?

- Watch the video on <https://niftidiver.com> , read the User's Manual (pages 6 to 13)
- Then launch your DSMB a few times with the Nifti-Reel – we suggest you start in the pool: half an hour is enough to practice several times in complete safety.
- Then go diving, and you'll find it easy and safe to launch your DSMB!



Video

<https://niftidiver.com>

✉ info@niftidiver.com

2. How can the Nifti-Reel be so easy to use?

2.1 The difficulty of managing the DSMB depends primarily on how you store the line

- Using a simple lead-weighted line is time-consuming and creates a serious risk of tangling.
- Using a Finger Spool requires dexterity and training, because you'd in fact need three hands (to hold the spool + the DSMB + the inflation device): there's a real risk of dropping the spool (even more in cold water with thick gloves).
- Using a Reel presents other risks: the line can get caught in a number of ways, and you risk being pulled abruptly to the surface. Sturdy reels are very heavy: drop a reel in the water for a moment and you lose it (the reel will sink instantly)

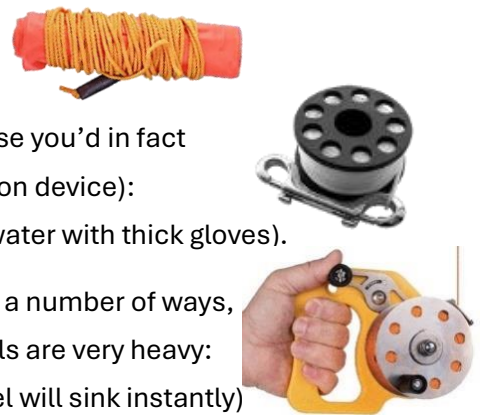

And unfortunately for less experienced divers, at shallow depth you have to inflate your DSMB a lot, which greatly increases your buoyancy and therefore the difficulty.

2.2 Solution : A long journey to radical ergonomics!

- Our aim is to make every stage in managing the DSMB easier, faster and safer.
Over a three-year development period, several divers – experienced but above all beginners – tested fourteen successive prototypes: any problems encountered have been meticulously analyzed and corrected (Patents granted).
- Today, with the Nifti-Reel, you can launch your DSMB easily, quickly and safely...
... without intensive or repeated training! And also with thick gloves!

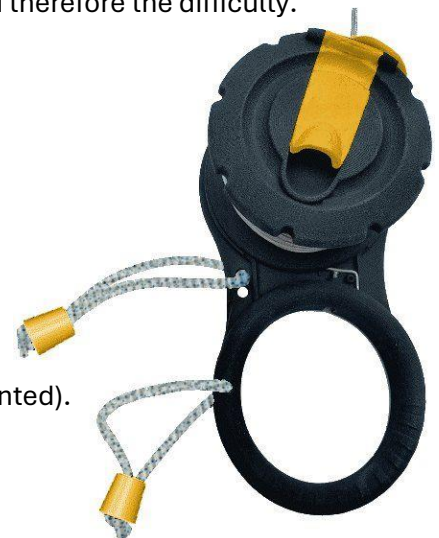

2.3 Summary Of My Benefits When Using The Nifti-Reel

(Features marked “New” are unique to the Nifti-Reel – Patents granted).

1. Even for beginner divers, launching the DSMB with the Nifti-Reel is easy, safe and quick (approx. 30 seconds): This limits depth changes, which is safer at shallow depths. This also applies in situations of stress or loss of dexterity (in cold water with thick gloves).
2. During the dive, the Nifti-Reel spool is locked and the line cannot unwind, but before inflating the DSMB you cannot forget to unlock the spool. **New**
Unlike commercially available reels, with the Nifti-Reel you can be totally sure that the line is – and remains unlocked, and this ...
 - ... without having to manipulate any mechanism:
in an emergency or stressful situation, you won't risk forgetting it;
 - ...without having to hold a lever down during the entire ascent of the DSMB
you won't risk your finger slipping or releasing this lever due to the vibrations.
3. Without any modification, the Nifti-Reel can be used with both hands. You can change hands in an instant (to move the DSMB from an obstacle, to assist a companion...)
4. The Nifti-Reel is very light (less than 0.53 lbs. / 240 grams):
 - This low weight makes it ideal for air travel.
 - During the dive, you can hang the Nifti-Reel attached to the DSMB in your favorite place (on your chest, on your hip, behind you), or carry them in a pocket: the Nifti-Reel's low weight won't affect your trim.
 - Drop it in the water, the Nifti-Reel will sink slowly. (In practice, if your DSMB contains a few milliliters of air, the Nifti-Reel & DSMB assembly will have roughly neutral buoyancy).
5. Holding the Nifti-Reel is effortless and doesn't monopolize your fingers:
 - Relax your fingers, and the Nifti-Reel won't fall off. **New**
 - Above all, all your fingers remain free to manage your DSMB. **New**
6. A host of Nifti-Reel features combine to protect your line from tangles and blockages:
 - Around 0.2" / 0.5 cm of free space is left at the edge of the spool, and the line doesn't swell (it doesn't absorb water). This prevents the line from coming off the spool.
 - Even in the line were to come off the spool, it cannot get caught under the spool. (The line diameter is greater than the clearance between the support plate and the spool.)
 - The rounded shape of the Nifti-Reel prevents the line from catching on it.
 - As the DSMB ascends, the rewind crank is stored inside the spool, making it impossible for the line to catch on it! **New**

7. As the DSMB ascends, it unwinds the line and the spool turns quickly, but absolutely no vibrations are transmitted to your hand! **New**
8. Thanks to the vertical orientation of the Nifti-Reel and the position of the line guide (at the top), the line turns little as it passes through the line guide, so it presses very little against it: **New**
 - This greatly limits line friction and wear
 - It helps any possible knot in the line pass through the line guide
 - It rests your hand
(you don't need to apply torque to the Nifti-Reel to maintain its orientation).
9. As the spool is very light and is braked, it stops immediately as soon as the DSMB reaches the surface: the line instantly stops unwinding (without the risk of tangling).
10. If a boat's propeller catches line, letting the Nifti-Reel urgently go is easy and instantaneous, even when wearing the thickest gloves: just let your wrist rotate.
11. During your ascent to the surface, rewinding is effortless thanks to the deployable crank. Clicks help you monitor your ascent rate without having to constantly check your computer. This may help you maintain your Situational Awareness.
12. Locking/unlocking the Nifti-Reel line at a stop is quick and easy, even with gloves.
13. Personalizing your Nifti-Reel is easy thanks its big, erasure-proof label. **New**
14. With its crank handle parked, the Nifti-Reel is compact: you can store it with a large DSMB (6" / 183 cm) in a suit cargo pocket. The Nifti-Reel support plate may look large, but in fact it's the same length (7.9" / 20 cm) as a large rolled-up DSMB.
15. The Nifti-Reel materials are robust but soft: they won't scratch the wooden bench or other surfaces of a dive boat or inflatable boat. They are resistant to shocks, corrosion, U.V., permanent immersion in salt water, and fungi. Disassembling, cleaning, and reassembling the Nifti-Reel is easy.
16. The Nifti-Reel has been designed and is manufactured with sustainability in mind, making it an environmentally friendly choice: The Nifti-Reel is 100% recyclable; material markings on parts facilitate recycling.

3. Nifti-Reel User Manual

3.1 On Land: How to prepare the Nifti-Reel and the DSMB

- The Nifti-Reel is supplied with a large Line Stop that is easy to grip even with gloved fingers.

You can choose to:

- 3.1.1 Either attach the DSMB permanently to the Nifti-Reel, and carry them together suspended from a D-ring on your rig.
- 3.1.2 Or attach the DSMB permanently to the Nifti-Reel, and carry them in a cargo pocket.
- 3.1.3 Or keep the DSMB and then Nifti-Reel separate and carry them in the pocket(s).



3.1.1 Either attach the DSMB permanently to the Nifti-Reel, and carry them together suspended from a D-ring on your rig

- Remove the Line Stop and put it away.
- Tie a single-end bolt snap to the line's end and the DSMB.

If you prefer, attach the line to the DSMB and use a double-ender

Advantages:

- 1) Thanks to the Nifti-Reel's low weight, you can hang it wherever you like: on your chest, your hip, behind you... – it won't affect your trim.
- 2) Keeping the DSMB permanently attached to the line makes life easier and saves time before launching the DSMB.
- 3) With the bolt snap attached, there's no risk of losing it.

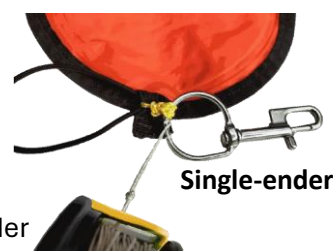

3.1.2 Or attach the DSMB permanently to the Nifti-Reel, and carry them in a cargo pocket

- Remove the Line Stop and put it away
- Tie the line's end directly to the DSMB. You don't need a carabiner.
- In a pocket, the line won't unwind (the Nifti-Reel has a brake).

Advantages:

- 1) The Nifti-Reel's low weight won't affect your trim.
- 2) Keeping the DSMB permanently attached to the line makes life easier and saves time before launching the DSMB.



3.1.3 Or keep the DSMB and the Nifti-Reel separate and carry them in a pocket

- Keep the line stop at the end of the line.
You'll need to hook the DSMB to the line before inflating.
- In a pocket, the line will not unwind (the Nifti-Reel has a brake).



3.2 Before a dive: How to attach the DSMB to the Nifti-Reel and lock its spool

3.2.1 If you carry the Nifti-Reel and the DSMB suspended together to a D-ring

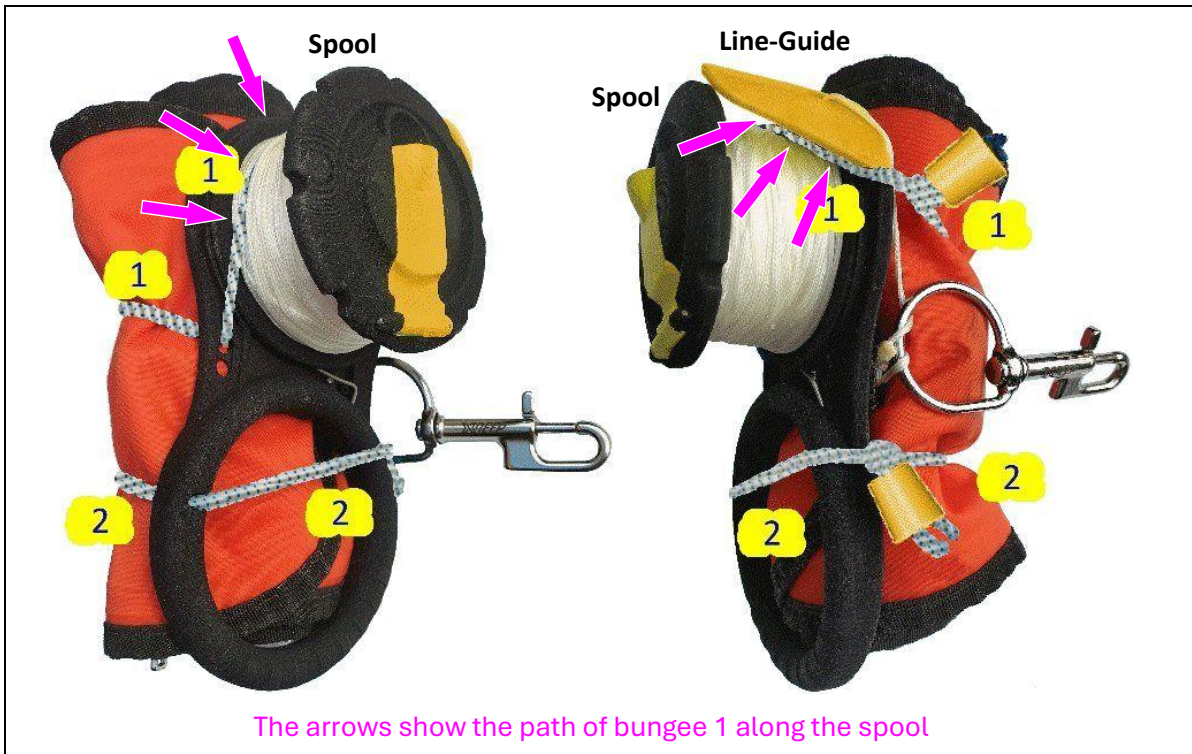

- Place the DSMB right up against the Nifti-Reel, on the opposite side of the spool.

- Bungee 1:

- Let bungee 1 pass between the spool and the Nifti-Reel line guide

The arrows show the path of bungee 1 along the spool

- and wrap bungee 1 around the DSMB.

Bungee 1 blocks the spool: it prevents the line from spontaneous unwinding.

- Bungee 2:

- Wrap it around the Nifti-Reel and the DSMB.

- Depending on the thickness of your DSMB,

adjust the length of both bungees

to ensure the DSMB is tight and the spool is locked.



3.2.2 If you carry the Nifti-Reel and the DSMB in pocket(s)

- No need for bungee 1: Remove it and store it away.

3.2.3 If you gave a small DSMB

- See "4.5 Add attachment points to the Nifti-Reel. Attaching a small DSMB"



3.3 How to hold the Nifti-Reel (even with the thickest gloves)

- The Nifti-Reel is designed to be used with the left or right hand and with the thickest gloves: Size 2XL/U.S. 11 Heavy Duty 5-Finger Drysuit Gloves, with heated under-gloves.

- When in horizontal trim with your hands lower than your body, the most comfortable way is probably to hold the Nifti-Reel with your thumb...

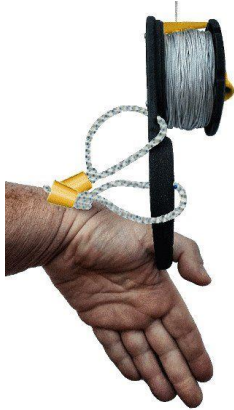

1: ... with your left-hand thumb

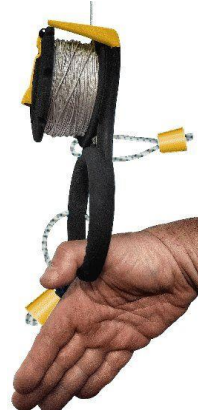

2: ... with your right-hand thumb

Stick your thumb through the opening (the opening is not for the hand!) and hold the Nifti-Reel loosely in the hollow between your thumb and forefinger:

Make no effort with your hand, relax your fingers, and do not squeeze the handle.

- Holding the Nifti-Reel with two fingers may also be comfortable:

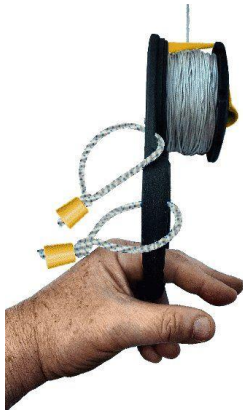

3: with two fingers of your left hand



4: with two fingers of your right hand.

Run two fingers through the opening. *Relax your fingers, do not squeeze the handle.*

- Just keep your hand pointed in the right direction and relaxing your fingers won't make the Nifti-Reel fall. Note: if you drop the Nifti-Reel, it will sink slowly and the line won't unwind.
- If needed, for example, if the line is caught in a boat propeller, releasing the Nifti-Reel is immediate. Just let your wrist turn, your hand will not get stuck even with the thickest gloves.
- You may **change hands instantly** (for example to move the DSMB away from an obstacle)
- **Above all, your fingers remain available to manipulate any other object: this will make inflating your DSMB much easier and safer.**

3.4 How to launch your DSMB

- Relax (because launching the DSMB is easy with the Nifti-Reel) and to further improve your safety, force yourself to proceed calmly, with deliberately slow (thus very precise) movements.

a) **Check that the crank is parked inside the spool** (this will prevent the line from catching on the crank).

b) Hold the Nifti-Reel **as shown in the photos:**

- Pass your thumb through the handle and place the two bungees in the palm of your hand (this keeps them away from the spool and DSMB).

- The spool on the opposite side of the DSMB
- Grab the DSMB Low-Pressure inflation nozzle with your fingers⁽¹⁾.

c) Using the other hand, inflate the DSMB a little, just enough for it to straighten up vertically.

d) To avoid tangling, check that the line is reasonably taut, **if necessary, rewind it.**

e) Now check the surroundings, the absence of obstacles above you and your depth. Prepare to exhale, put yourself in slightly negative trim, ready to kick down.

f) While maintaining your depth (if necessary, exhale and kick down), inflate the DSMB and look at its volume: as soon as it is sufficiently inflated, release it.

- Remember Boyle's Law: for the DSMB to be 100% inflated on the surface, the initial volume of air needed depends on your depth: For example:

Inflation depth	Ambient pressure	Minimum volume to inflate
20 ft (6 m)	1.6 bar	$1 / 1.6 = 63\%$ (two thirds)
33 ft (10 m)	2.0 bar	$1 / 2.0 = 50\%$ (half)
69 ft (21 m)	3.1 bar	$1 / 3.1 = 32\%$ (a third)

Table: Inflation percentage required depending on the depth (where 100% = total DSMB volume).



⁽¹⁾ Inflating the DSMB with a Low-Pressure hose is one possible method.

You can also inflate with a regulator through the DSMB bottom opening, inflate orally ...

3.5 What happens during the DSMB ascent

- Note: Unlike other reels on the market, with the Nifti-Reel you can be absolutely certain that the spool is unlocked...
 - ... without having to operate a mechanism: in emergency or stress situations, you won't risk forgetting it;
 - ... without having to keep a lever continually depressed you won't risk your finger slipping or releasing this lever due to the vibrations
- As it rises, the DSMB pulls the line. The spool will spin quickly but it will not transmit unpleasant vibrations to your hand.
 - When the crank is parked, the spool is highly symmetrical so it vibrates very little,
 - And in any case, holding the Nifti-Reel loosely actually isolates your hand from the slightest vibration.
- Given the orientation of the Nifti-Reel (vertical) and the position of the line guide (at the top), the line turns little as it passes through the line guide and therefore exerts little or no force on the line guide:
 - this greatly reduces line friction and wear;
 - it also helps any possible knots in the line to easily pass through the (large) window;
 - also, you must not exert any effort with your wrist or hand to maintain the Nifti-Reel's orientation (it spontaneously maintains its near-vertical orientation).
- The Nifti-Reel spool is very light, and braked: when the DSMB reaches the surface, the spool stops spinning instantly: there is no risk of unwinding line unnecessarily and causing tangles.
- Note if you are diving in a drysuit: While holding the Nifti-Reel, your arm remains horizontal, so your drysuit overpressure valve (OPV) will not open: there's no need to close the OPV before launching the DSMB.



3.6 During your ascent: How to rewind the line



Lift the crank and extend it

To rewind, turn the crank clockwise.

- For your own safety, it is advisable to maintain a more or less neutral buoyancy throughout your ascent ⁽²⁾, which also allows you to rewind effortlessly.

In practice, do not pull yourself up in the line:

1. take a breath or kick a little to ascend a little,
2. breathe out and rewind the excess line effortlessly,
3. adjust your buoyancy and start again at step 1.

That said, if you happen to be negatively buoyant, rewinding remains easy as the pull-out handle considerably reduces the effort required.

- Rewind generates audible clicks that you can feel in your fingers. Their rate can help you control your ascent speed without having to constantly look at your dive computer (depth gauge): This can help you maintain situational awareness.
- If needed, the pull-out handle allows for effortless and fast rewinding.

⁽²⁾ Remaining neutrally buoyant saves you from sinking quickly if you would need to release the DSMB.

3.7 At a stop: How to lock/unlock the spool

- At a stop, to allow your DSMB to rise above the water surface, you can pull the Nifti-Reel slightly downwards. To do this, you may want to adjust the brake force to suit your preference (See next page: "3.9 On Land: how to check and adjust the brake").
- On the other hand, locking/unlocking the spool at a stop is very easy. Several methods are possible, for example:

- Method 1 (recommended):

Grasp the line above the line guide, and wind the line half a turn around the spool in the "REWIND" direction (the direction is indicated on the crank).

- This method is easy even with thick gloves.
- Its advantage is that you can continue to use both hands for other tasks, such as assisting your buddy — you may want to use this method for long stops.

(To release the line: grasp the line above the spool and unwind it a half turn.)

- Method 2:

Grab the spool and/or the crank with your full hand.

- This is the fastest method, but
- it takes up your hand — you may want to use this method for a short stop

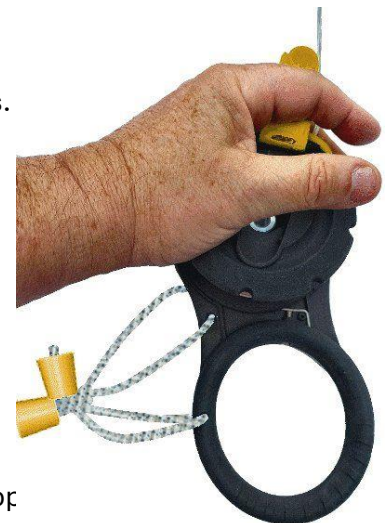

3.8 Before getting back on board: How to lock the spool

- Here you are on the surface next to the boat or the RHIB (Rigid-Hull Inflatable Boat, a.k.a. Zodiac); you prepare yourself to get back on board, and you may want to pass the DSMB and Nifti-Reel off to the crew.

To prevent the line from unwinding:

Wrap bungee 2 around the Nifti-Reel spool.

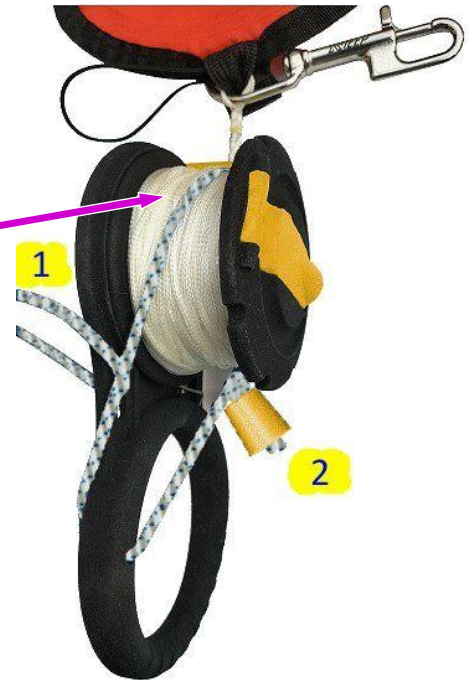

3.9 On Land: When should I rinse my Nifti-Reel?

- The Nifti-Reel is designed for sea diving: it's robust and resistant to shocks, U.V./sunlight, permanent immersion in salt water, bacteria, and fungi.
- At the end of a series of sea dives, we recommend rinsing the Nifti-Reel with fresh water.
- After diving in a pool with chlorinated water, we recommend rinsing the Nifti-Reel with fresh water.
- Before adjusting the brake (see "[4.2 On Land: How to check and adjust the brake](#)"), the Nifti-Reel must be rinsed with fresh water.

4. Technical Documentation

4.1 On Land: How to attach the line to the spool

- Pass the line through the line guide, then attach it to the spool (2 methods):

- Method 1:

- Thread the line through one of the two holes in the spool.

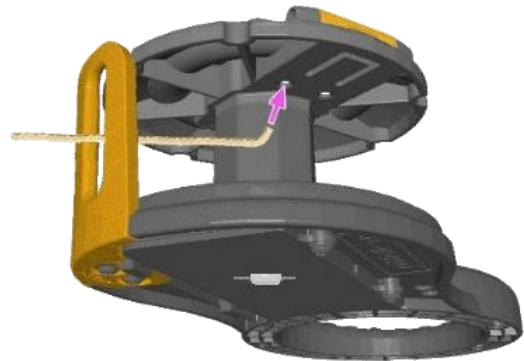

- Tie a knot at the end of the line.

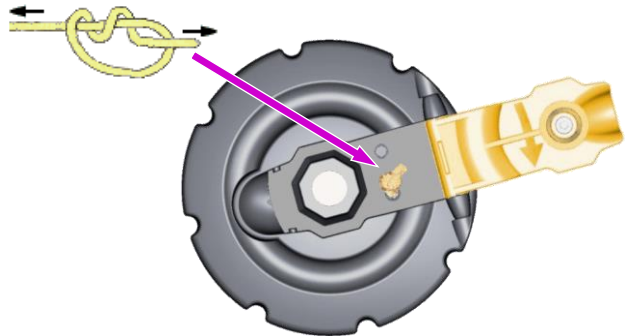

- Method 2:

- Make a slipknot, pass the loop around the spool (in the same direction as in the image, then the octagonal central column prevents the line from slipping).
- Tighten the loop and wind.

Note: With Method 2, detaching the line from the Nifti-Reel is quick.



4.2 On Land: How to check and adjust the brake

- The brake is adjustable on land with the Size 2 Allen® key supplied with the Nifti-Reel. (During a dive, there is no risk of unintentionally changing the brake setting.)



- **Procedure (on Land)**

- Attach a known weight to the line, e.g. **2 lbs. / 1 kg lead** ⁽³⁾
 1. Hold the Nifti-Reel in the air (with the weight suspended at the end of the line)
 - if the line unwinds (if the lead weight drops), increase braking, and then start again at 1.
 2. At this stage, when you hold the Nifti-Reel in the air, the line doesn't unwind. Now raise your hand abruptly by a few inches:
 - if the line unwinds, the adjustment is complete!
 - if the line doesn't unwind, decrease braking, and then start again at 1.
- Gradually adjust the brake it to your preferred value:
When diving, launch the DSMB and check the brake (also during a stop); adjust only slightly on land – a quarter turn at a time, for example.
- For information: most divers adjust the brake between 1 and 3 lbs. / 0.5 and 1.5 kg.

⁽³⁾ The line will unwind in the water if the DSMB contains more than 1.0 liters of air and the Nifti-Reel will exert an upward pull on your hand, limited to approx. 2 lbs. / 1 kg.

4.3 On Land: How to personalize your Nifti-Reel

- The Nifti-Reel is fitted with a big label:
 - Write on this label with a water-resistant marker.
Wipe with alcohol / acetone / petrol... ⁽⁴⁾
 - Your text is protected against rubbing by a transparent window
- To access this label:
 1. Remove the window with the Torx® T10 key supplied with the Nifti-Reel.
 2. On the label, you may for example write the length of the line, your (first) name, the name of the boat, and the mobile phone number of the Dive Manager.
 - This allows you and the other divers on the boat to quickly identify your equipment.
 - And it could save your life or avoid unneeded Search And Rescue costs: if another boat or Coast Guards find your Nifti-Reel and DSMB on the surface of the sea, by calling your boat they will know if you are back on board.

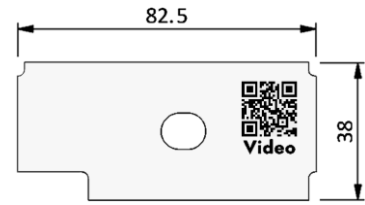

3. Check that the retaining pin is seated on the axle:

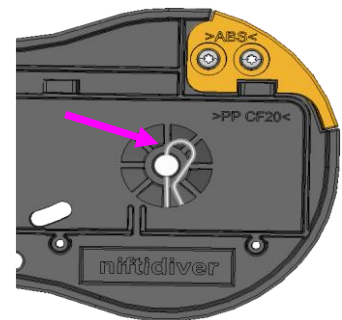

4. Put the label in place, then put the window back in place (there is only one possible position), and screw the two screws back in ⁽⁵⁾.



Safety Warning: The transparent window MUST be installed and screwed in place because it protects the axle locking pin from unintentional removal

⁽⁴⁾ The label is made of HDPE (High Density Polyethylene): it is highly resistant to tearing, U.V. (sunlight), salt water and many chemicals.

⁽⁵⁾ To avoid damaging the threads, do not overtighten the screws. We suggest using only two fingers on the wrench when tightening.

4.4 On Land: How to disassemble, clean, and reassemble the Nifti-Reel

1. The Nifti-Reel is easy to dismantle and reassemble, for example to clean it of sand or biological residues
 - Using the Torx® T10 key supplied with the Nifti-Reel, unscrew the transparent window.
 - Remove the window, the label, the axle locking pin, the spool, and its axle.
 - Clean all parts with fresh water.

2. To reassemble the spool
 - If necessary, unscrew the brake adjustment screw, or move the spring away from the center of the spool (using a flathead screwdriver).
 - Refit the spool and the axle.
 - Fit the axle locking pin in place (see image on the previous page).
 - Fit the label, and screw the window in place (two screws)⁽⁶⁾.



Safety Warning: The transparent window MUST be installed and screwed in place because it protects the axle locking pin from unintentional removal.

⁽⁶⁾ To avoid damaging the threads, do not overtighten the screws.

We suggest using only two fingers on the wrench when tightening.

4.5 Add attachment points to the Nifti-Reel. Attaching a small DSMB

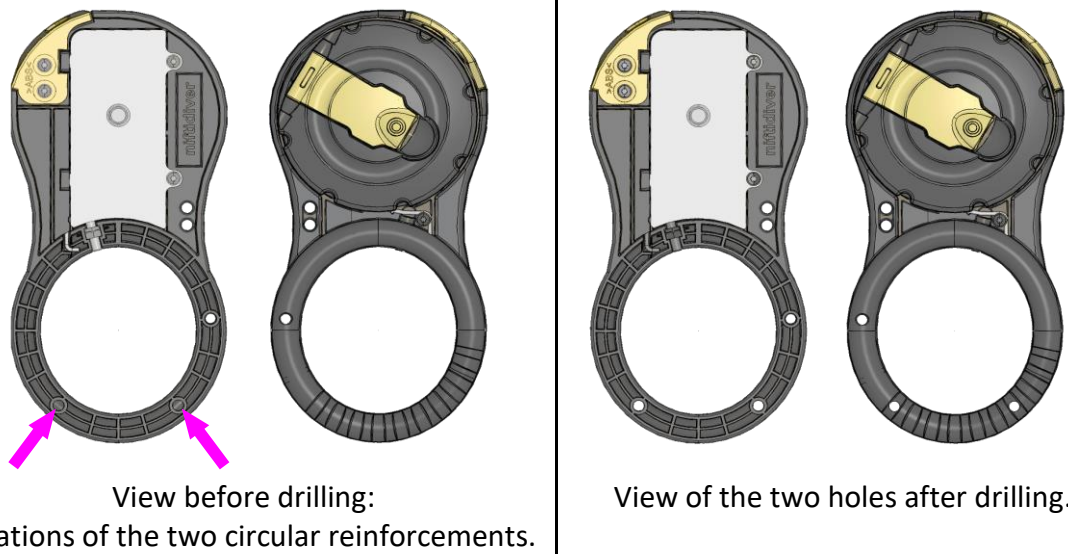

The Nifti-Reel handle has two circular reinforcements. You can drill a hole with a **diameter of 3/16" (5 mm)** ⁽⁷⁾ at the center of each of these reinforcements. It's easy (reinforcements guide the drill bit), and risk-free (it will not affect the strength of the Nifti-Reel).

This allows, for example, to attach a small DSMB to the Nifti-Reel:



A small DSMB attached in two different ways to the Nifti-Reel (single bungee)

⁽⁷⁾ The Nifti-Reel handle is made of Carbon fiber reinforced polypropylene: use a 3/16" (5 mm) diameter HSS drill bit (metal drill bit).

4.6 Dimensions. Weight. Buoyancy. Line



- **Size/Dimensions**

- 7.9" × 3.8" × 2.6" / 200 mm × 97 mm × 67 mm

A large DSMB (6 ft/183 cm) and a Nifti-Reel can be stowed into a suit cargo pocket (a large rolled-up DSMB has the same length of 7.9" / 200 mm).

- Cold water divers can use the Nifti-Reel with the thickest gloves:
Size 2XL/U.S. 11 Heavy Duty 5-Finger Drysuit Gloves, with Heated Under-gloves.
- Bungees diameter: .16" / 4 mm

- **Weight**

- Less than .53 lb. (240 grams), including the line.

- **Buoyancy**

- Slightly negative. If you drop the Nifti-Reel underwater, it sinks slowly (and the line does not unwind). In practice, if your DSMB contains a few milliliters of air, the "Nifti-Reel + DSMB" assembly will have approximately neutral buoyancy.

- **Line**

- **Version 1: Dacron®/Polyester**, braided. High viz. yellow. **Length 132 ft (40 m)** ⁽⁸⁾.
Twine size #30 – Dia .079" (2.0 mm). Breaking strength **220 lbs.** (100 kg / daN).
Specific gravity 1.38 (sinks).
- **Version 2: Dyneema®**, braided, with high viz yellow urethane protective coating.
Length 200 ft (60 m). Other lengths on request, up to max. 410 ft (125 m) ⁽⁸⁾.
Twine size #6 – Diameter .033" (0.85 mm). Breaking strength **286 lbs.** (130 kg / daN).
Specific gravity 0.98 (slightly buoyant).

⁽⁸⁾ Line characteristics that prevent jamming:

- As PES and Dyneema® do not absorb water, the line does not swell: this prevents the line from locking itself on the spool.
- The chosen max line lengths leave around .2" (5 mm) free on the periphery of the spool, which prevents the line from coming off the spool.
- Even if the line came off the spool, it cannot jam under the spool, because the diameter of the line is greater than the clearance between the support plate and the spool.

4.7 Materials and Respect of the Environment

- **The Nifti-Reel is designed for sea diving:**
it is robust, impact-resistant, U.V./sun and corrosion resistant.
It is resistant to permanent immersion in salt water, bacteria and fungi.
- **Materials**
 - Metal parts: Marine Quality Stainless Steel (A4 / AISI 316 / DIN 1.4401).
 - Support plate: Carbon Fiber reinforced Polypropylene (PP-CF20). This material is rigid and robust, but it won't scratch wooden benches or other surface of a dive boat or inflatable boat (RHIB)
 - Spool: ASA (Acrylonitrile Styrene Acrylate). ASA has superior resistance to weathering and U.V. It does not absorb water, it is very rigid and resists warping.
 - Spool axis: POM (Polyoxymethylene, acetal, Delrin®).
POM does not absorb water and therefore retains its dimensions and rigidity even when permanently immersed in salt water.
 - Line guide, line stop, bungee stops, crank, handle: ABS (Acrylonitrile Butadiene Styrene), anti-U.V. treated and yellow-colored in the mass (not just on the surface). ABS is rigid and resistant (classic LEGO® bricks are made of ABS).
 - Transparent window: PETG (Polyethylene Terephthalate Glycol).
PETG is robust and resistant to U.V., chemicals and impact.
 - Label: HDPE (High Density Polyethylene). Write with a permanent marker, wipe with alcohol/acetone/thinner/gasoline... (HDPE is highly resistant to chemicals.)
 - Bungees: Marine-grade construction: natural latex core, with HT (high tensile) Polyester sheath. Resistant to rot, U.V., salt water and chemicals.
 - Line: See previous page
- The Nifti-Reel has been designed and is manufactured with sustainability in mind, which makes it an environmentally friendly choice: all parts can be recycled and material markings facilitate recycling.

4.8 Note : Rewind handle, line stop. Bungee stops.

- These parts are similar, so here's how to tell them apart:
 - The rewind handle and line stop are alike and their lateral surface is smooth.
 - Both bungee stops have a larger central hole and their lateral surface is ribbed.

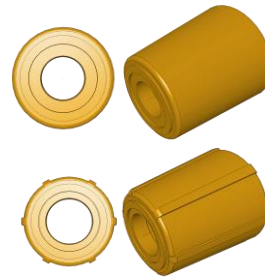

4.9 Note : How to mount the brake

- The Nifti-Reel is delivered with the brake fitted: fitting instructions are given here only for information.

1) Lay the Nifti-Reel horizontally on the work surface

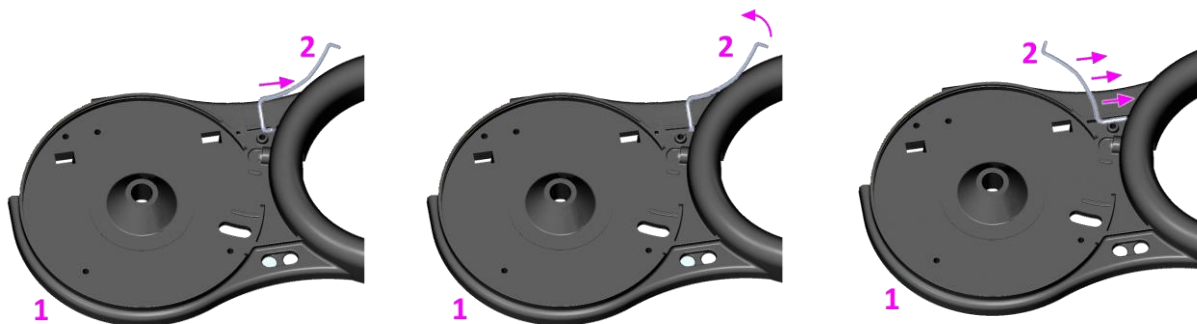
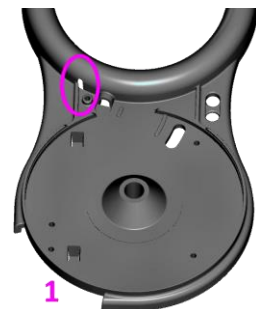

2) Present spring #2 in a vertical plane and press in, turn it through 90 °, and gently press it into the bottom of the hole.

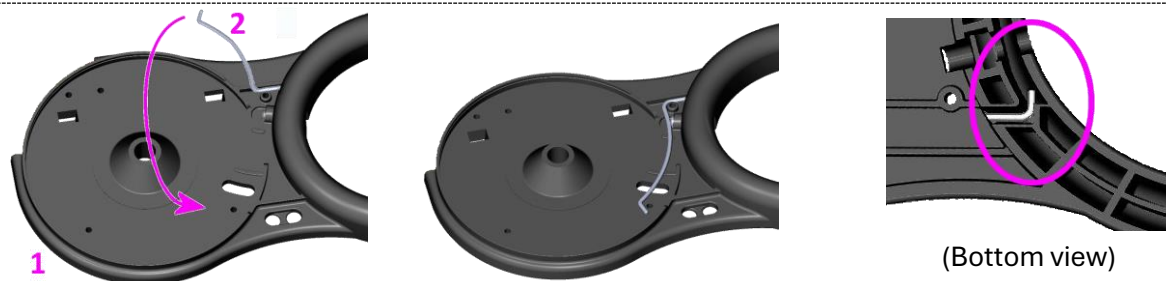

3) Carefully fold the spring back onto the support plate #1

- 4) Gently tighten screw #3 (Torx® T10)

This screw simply prevents the spring from lifting:

To avoid damaging the threads, do not overtighten the screw. We suggest using only two fingers on the wrench when tightening.

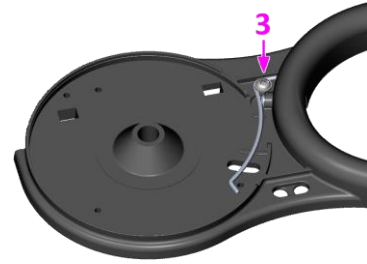

- 5) Place support #1 on the work surface

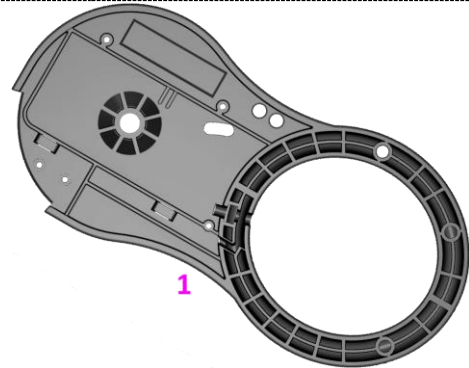

- 6) Insert screw #5 into Nyloc nut #4; tighten screw with size 2 Allen key until nut #4 is approximately in the middle of screw #5

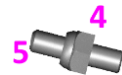

- 7) Place nut #4 at the bottom of its cage, screw in screw #5 until it just touches spring #2 (on the other side of support #1).

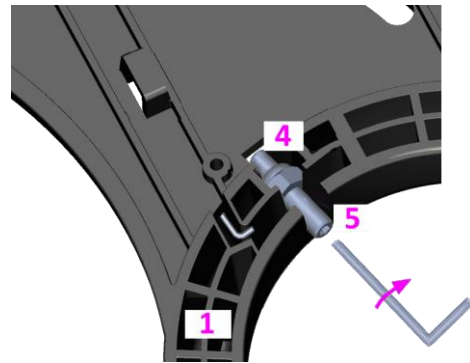

- 8) Brake adjustment: See "[4.2 On Land: How to check and adjust the brake](#)"

4.10 Trademarks

- Allen®, Dacron®, Delrin®, Dyneema®, LEGO® and Torx® are registered trademarks respectively of Apex Brands, Inc., Invista, DuPont Inc., DSM IP Assets B.V., The Lego Group and Camcar/Textron Inc.



<https://niftidiver.com>

e-mail : info@niftidiver.com

Nifti-Reel: At last, I can launch my DSMB without stress!